

Sockets



T-Rex Socket

Type Approved by DNV-GL

Offshore accessory to be used for Temporary, Mobile and Long Term Mooring
as defined in DNVGL-OS-E301, Position Mooring

Type Approved by ABS

For use on an ABS classed vessel, MODU or facility

as defined in 2009 ABS guide for Certification of Offshore Mooring Chain (updated 10 February 2014)

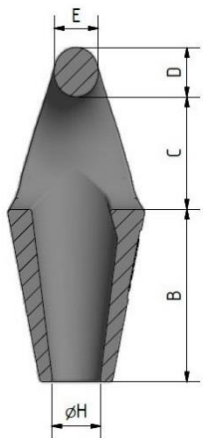
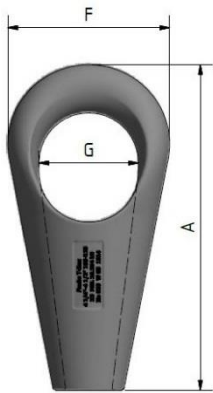

Rope	A	B	C	D	E	F	G	H	R3 MBL kN	R4 MBL kN
31-36	267	138	90	40	35	132	81	38	1189	1416
37-42	312	161	105	46	41	155	95	44	1599	1965
43-48	356	184	120	53	47	177	108	50	2064	2536
49-54	401	207	134	59	53	199	122	57	2581	3171
55-60	445	230	149	66	59	221	136	63	3147	3867
61-68	505	260	169	75	67	250	154	71	3977	4886
69-75	542	280	182	80	72	269	165	77	4767	5875
76-80	594	306	199	88	78	294	181	84	5367	6594
81-86	638	329	214	95	84	316	194	90	6123	7523
87-93	690	356	232	102	91	342	210	98	7052	9002
94-102	757	391	254	112	100	375	231	107	8316	10217
108-115	846	437	284	125	112	420	258	120	10264	12610
122-130	965	498	324	143	127	478	294	137	12663	15559



Type Approval by:

DNV-GL, ABS for 31 - 130 mm

Application:

Temporary, Mobile and Long Term Mooring

Manufactured & Tested:

in Germany by Feubo

Material:

Cast Steel – Grade R3, R4

Features:

installation on all vessels classed by DNV GL, MODU classed by ABS